

# Conference Suite 2

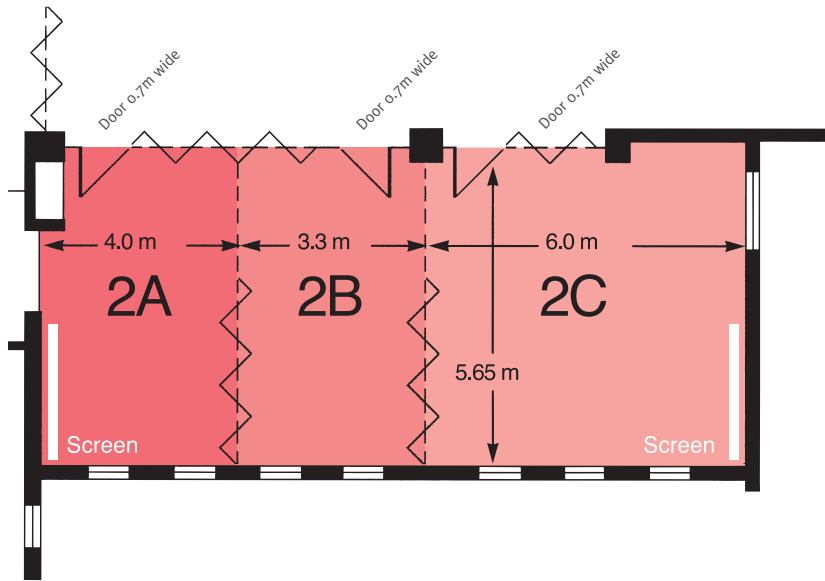

T 0115 846 8000 F 0115 951 5009 emcc@nottingham.ac.uk

This room can be partitioned into three distinct areas each with separate functions.

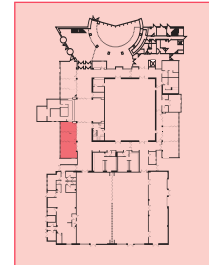

Ceiling height 2.99 m

Clear access height 2.54 m

## FACILITIES

		AREA	A	B	C	A and B	B and C
		COMPLETE SUITE					
Capacities	Theatre style	100	30	20	40	50	70
	Board room	42	16	16	18	24	30
	Classroom	40	13	11	12	17	28
Lighting	Fluorescent	yes	yes	yes	yes	yes	yes
	Controls in room	yes	yes	yes	yes	yes	yes
	Blackout to windows	yes	yes	yes	yes	yes	yes
Sound	Sound system	stereo	stereo	stereo	stereo	stereo	stereo
	Number of speakers	2	0	2	0	2	2
	Number of mike inputs	3	3	0	0	3	0
	Number of line inputs	1	1	0	0	1	0
	Controls in room	yes	yes	yes	yes	yes	yes
Power	13 amp sockets		Perimeter trunking with 84 x 13 amp sockets				
Projection	Number of screens	2	1	0	1	1	1
	Size	1.92x2.62 1.92x3.62	1.92x2.62		1.92x3.62	1.92x2.62	1.92x3.62
	Height off floor	0.97 m	0.97 m		0.97 m	0.97 m	0.97 m
Communications	Telephone points	7	2	2	3	4	5
	Data	7	2	2	3	4	5